

PG8765NE

NO.	DESCRIPTION	SPEC.	NO.	DESCRIPTION	SPEC.
1	FUEL TANK		36	AVR	
2	BUSHING	Φ8.7XΦ12.2	37	ALTERNATOR BRACKET	
3	OIL TANK DAMPING RUBBER PAD	Φ12XΦ14X12	38	STATOR FIXING BOLT	M5
4	FUEL CONTROL VAVLE		39	STANDARD SPRING WASHER	Φ5
5	FLAT WASHER	Φ6XΦ22X2	40	STATOR FIXING NUT	M5
6	BOLT	M6	41	ROTOR BOLT	M10
7	FUEL METER		42	FLAT WASHER	Φ10XΦ32X4
8	CROSS RECESSED CONTERSUNK HEAD SCREW	M5	43N	STATOR	
9	FUEL FILTER		44N	ROTOR	
10	FUEL TANK CAP		45	WIND SCOOPER	
11	FRAME		46	PANEL MAIN WIRE HARNESS ASSEMBLY	
12	SHOCHPROOF FOOT(RIGHT)		47	PANEL REAL COVER	
13	NUT-FINE THREAD	M10	48	RECTIFIER BRIDGE	
14	SHOCHPROOF FOOT(LEFT)		49	POWER SOCKET ASSEMBLY	
15	BATTERY BAND		50	POWER SOCKET ASSEMBLY	
16	BATTERY		51	TERMINAL	
17	NEGATIVE LINE	4.0	52	TERMINAL	
18	POSITIVE LINE	4.0	53N	VOLTMETER	
19	NUT	M8	54	SINGLE POLE CIRCUIT BREAKER	
20	ALTERNAOR BRACKET DAMPER BLOCK		55	CONTROL PANEL BODY	
21	SHOCHPROOF FOOT(RIGHT)		56	CONTROL PANEL BODY (SWITCH BOTTOM PLATE)	
22	UNIT POWER		57	SWITCH ASSEMBLY(ELECTRIC)	
23	AIR FILTER BRACKET		58	BOLT	M6
24	BOLT	M6			
25	ALTERNATOR RIGHT COVER STOPPER				
26	EXHAUST GASKET				
27	MUFFLER				
28	BOLT	M8			
29	STATOR BOLT	M6			
30	CARBON BRUSH				
31	TERMINAL				
32	BOLT	M5			
33	REAL COVER				
34	NUT	M5			
35	BOLT	M5			

PG8765NE VER2.1-EX-CK03P2026038ST

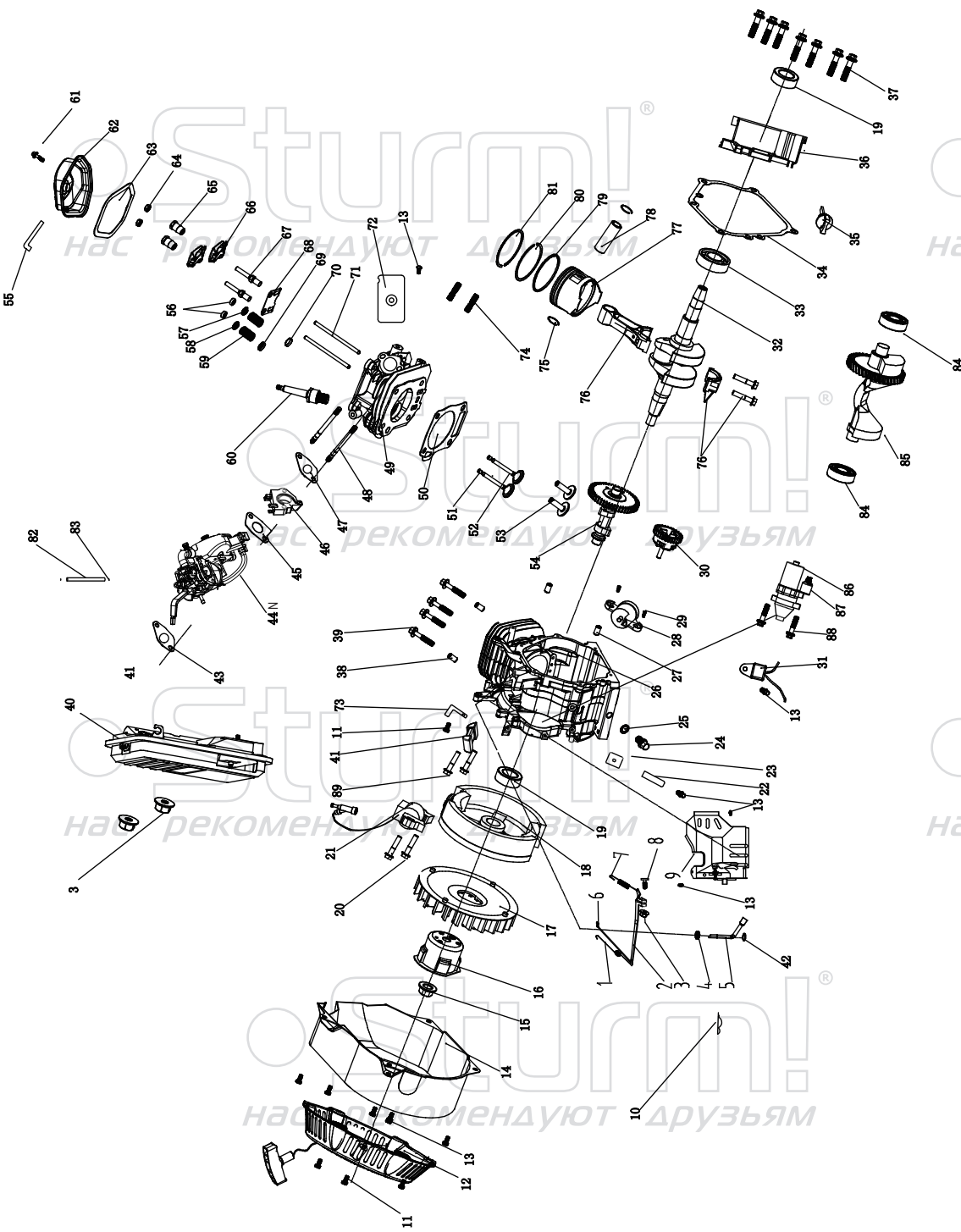



ENGINE FOR PG8765NE

NO.	DESCRIPTION	SPEC.	NO.	DESCRIPTION	SPEC.
1	RESET SPRING (THROTTLE VALVE)		46	INSULATION BOARD (CARBURETOR)	
2	CONTROL ASSEMBLY		47	AIR INLET GASKET	
3	NUT	M6	48	DOUBLE-SCREW BOLT	M6X8X110
4	CONNECTING ROA OIL SEAL	Φ8x14x4	49	CYLINDER HEAD	
5	GOVERNOR ARM		50	CYLINDER HEAD GASKET	
6	GOVERNING PULL ROD		51	INTAKE VALVE	
7	GOVERNING SPRING		52	EXHAUST VALVE	
8	FIXING BOLT OF SPEED CONTROL BRACKET		53	VALVE LIFTER	
9	OIL CONTROL SET		54	CAMSHAFT ASSEMBLY	
10	COTTER PIN		55	WASTE PIPE	Φ10.5X Φ5
11	BOLT	M6	56	VALVE ADJUSTING CAP	
12	HAND STARTER ASSEMBLY		57	EXHAUST VALVE SPRING SEAT	
13	BOLT	M6	58	EXHAUST VALVE SPRING SEAT	
14	HAND STARTER ASSEMBLY		59	VALVE SPRING	
15	NUT	M16	60	SPARK PLUG	
16	STARTING PULLEY		61	CYLINDER HEAD BOLT ASSEMBLY	
17	FLY WHEEL		62	CYLINDER HEAD COVER	
18	FLY WHEEL SET		63	CYLINDER HEAD GASKET	
19	OIL SEAL	Φ35XΦ52X7	64	NUT	
20	BOLT	M6	65	NUT	
21	IGNITOR COIL		66	VALVE ROCKER ARM	
22	WIRE CLAMP	10X100	67	ROCKER SHAFT BOLT	
23	RUBBER STOPPER		68	PLATE PUSH GUIDE	
24	BOLT	M12X1.5X15	69	OIL SHIELD	
25	GASKET	Φ12XΦ21X2	70	VALVE SPRING SEAT	
26	CRANKCASE		71	VALVE LIFTER	
27	LOCATION PIN	Φ8X14	72	WIND SCOOPER	
28	OIL ALERT		73	CHARGING COIL CLAMP	
29	BOLT	M6	74	DOUBLE-SCREW BOLT	M8
30	GOVERNOR GEAR SET		75	CLIP(PISTON PIN)	
31	OIL PROTECTOR		76	CONNECTING ROD	
32	CRANKSHAFT		77	PISTON	
33	DEEP GROOVE BALL BEARING		78	PISTON PIN	
34	GASKET(CRANKSHAFT)		79	CLIP(PISTON PIN)	
35	OIL GUAGE SET		80	CLIP	
36	CRANKCASE COVER		81	CLIP	
37	BOLT	M8	82	FUEL PIPE	Φ4XΦ8
38	LOCATION PIN	Φ12X20	83	CLAMP(FUEL PIPE)	Φ8
39	CYLINDER HEAD BOLT	M10	84	DEEP GROOVE BALL BEARING	
40	AIR CLEANER ASSY		85	BALANCE SHAFT	
41	CHARGING COIL		86	STARTING MOTOR	
42	GOVERNOR ROD GASKET	Φ8.4X19.5X0.8	87	STARTING RELAY	
43	GASKET(AIR CLEANER)		88	BOLT	M8
44N	CARBURETOR		89	BOLT	M6
45	GASKET(CARBURETOR)				